

**MAIN FLOOR**  
**639 SQ. FT.**  
**9'-2" CEILING**

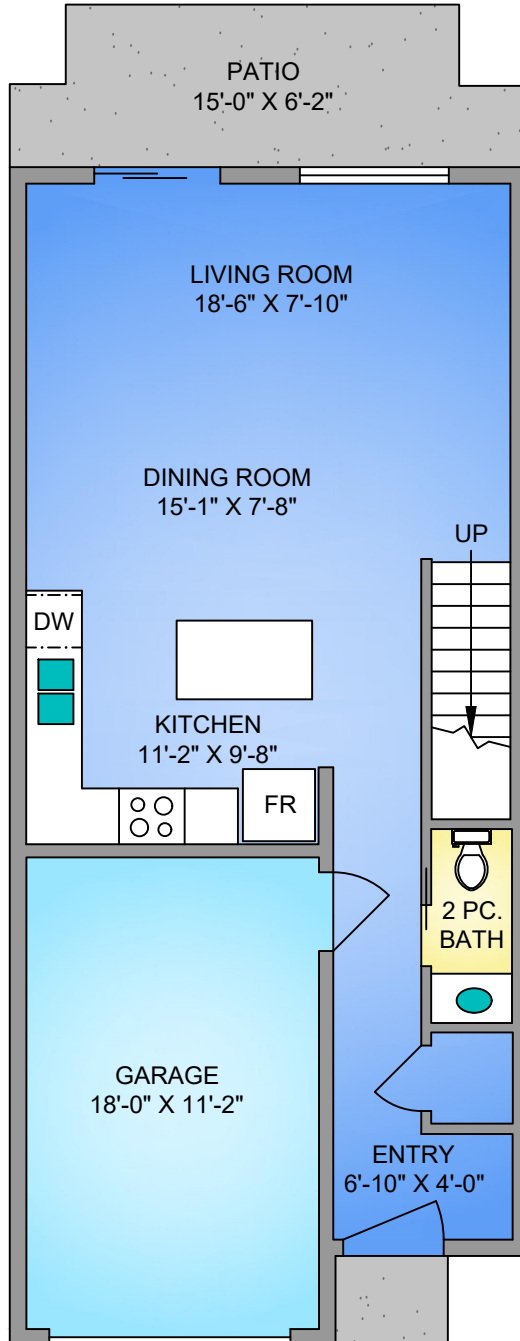

**UPPER FLOOR**  
**850 SQ. FT.**  
**8'-0" CEILING**



250-616-2482  
 PROPER MEASURE™ MID ISLAND  
 propermeasure.com  
 midisland@propermeasure.com

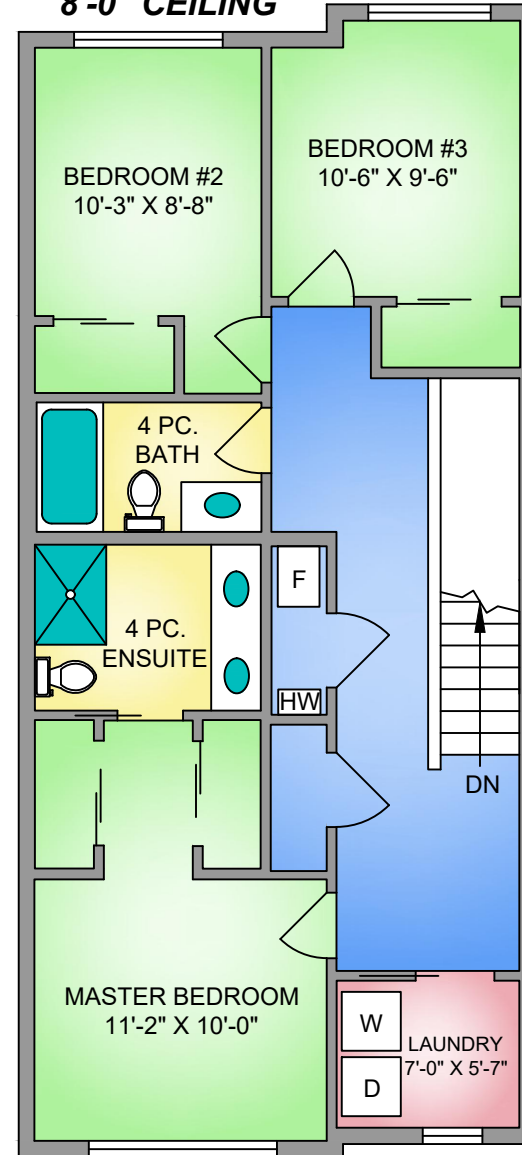

NORTH

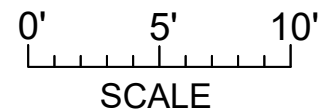

10-119 MOILLIET STREET  
 SEPTEMBER 3, 2020

Prepared by PROPER MEASURE MID ISLAND for the exclusive use of MITCH BUSSIERES  
 Plans may not be 100% accurate. Buyer must verify any critical measurement. Private resale or modification of floor plans to a third party by any individual or entity other than Proper Measure Mid Island is strictly prohibited

FLOOR	AREA (SQ. FT.)		
	FINISHED	GARAGE	DECK / PATIO
MAIN	639	221	108
UPPER	850	-	-
<b>TOTAL</b>	<b>1489</b>	<b>221</b>	<b>108</b>